

TECHNICAL FORM ENADA PRIMAVERA 2019

Form - EXHIBIT RATES

EXHIBITING RATES PER SQ.M. - BARE AREA		
	Up to 64 sq.m	Over 64 sq.m*
1 open side	€ 143.00	€ 128.00
2 open sides	€ 153.00	€ 133.00
3 open sides	€ 158.00	€ 138.00
4 open sides	€ 168.00	€ 141.00
Red Area Surcharge ⁽¹⁾	+ 15% on total bare area	

*Rate applicable to exceeding area only, i.e. the first 64 sq.m. will be applied the rate 'Up to 64 sq.m'.

EXHIBITING RATES TURNKEY** AREA ⁽¹⁾				
TURNKEY AREA	16 sq.m 1 open front	16 sq.m 2 open fronts	32 sq.m 1 front	32 sq.m 2 fronts
Type A4	€ 4,110	€ 4,270	€ 7,470	€ 7,790

**NB Turnkey areas are compulsory for stand requests smaller than or equal to 16 sq.m

Other items⁽¹⁾:

Registration Fee (mandatory for each exhibitor) € 750.00
covers insurance, exhibitors' badges according to exhibit area, listing in the official catalogue, local publicity taxes,
1 parking permit, Wi-Fi connection

Red area surcharge	+ 15% on bare area
Power Supply per kW monophasic	€ 43.50
Water Supply each	€ 169.50
Catalogue entry represented company each	€ 60.00
Hosted companies fee (in case of more companies inside one booth)	€ 600.00

VAT must be added to these figures, if due

NOTES:

The estimate of participation includes: registration fee + area rate per sq.m
Basic proposal example:

ESTIMATE Example – EXHIBITORS			
Registration Fee	€	750.00	+
1 open side area € 143 x 16 sq.m	€	2,288.00	+
Total	€	3,038.00	+ VAT

(1) Further details and costs of participation are indicated in the General Rules and Regulations of Exhibition.

(2) (1) **Red Area Surcharge**: Supplementary rate on the total area amount for those stands having at least one front or entirely placed between the two main passages (Chap. II Part 1 Art. 2 in Gen. Rules and Regulations).

Other services available: furnishing and fitting rent, cleaning, translators and hostess staff, loading and unloading items, audiovisual equipment renting etc. Those and more other services can be booked after signing the exhibiting proposal.

For further information please visit the website: www.enada.it

ARE YOU TEMPTED?

ADVERTISING SOLUTIONS for ENADA PRIMAVERA 2019

COMPANY NAME _____

Dear Participant,

We have pleasure in drawing your attention to some advertising opportunities to reinforce your visibility as exhibitor at the **31st edition of ENADA PRIMAVERA 2019**.

We suggest you taking into account these different options. In case you are interested, please tick the advertising solution you prefer and return this form by fax to the following email: leonora.giovannini@iegexpo.it or amanda.reggiani@iegexpo.it

DESCRIPTION		PRICE LIST
EXPO MAP		
<input type="checkbox"/>	4-COLOUR COMPANY LOGO ON VISITOR EXPO MAP (distributed for free to all visitors)	€ 900.00
OFFICIAL CATALOGUE		
<input type="checkbox"/>	4 COLORS COMPANY LOGO IN THE "EXHIBITORS LIST" SECTION	€ 300.00
<input type="checkbox"/>	FULL COLOUR PAGE	€ 1,000.00
WEBSITE BANNER WWW.ENADA.IT		
<input type="checkbox"/>	SECTION "VISITORS" AND RELATED PAGES	€ 500.00

WIDE ADVERTISING SPACES IN THE EXPO CENTRE

DESCRIPTION		PRICE LIST
<input type="checkbox"/>	SWAN STRUCTURE 2-SIDED BILLBOARD/SAIL (Two-sided support for 1x1.40 mt. billboard inside the Expo Centre)	€ 810.00
<input type="checkbox"/>	TOTEM AT THE RAILWAY STATION – 5 totems	€ 1,500.00
<input type="checkbox"/>	REVOLVING DOOR BRANDING - - SOUTH/WEST ENTRANCE	€ 7,000.00
<input type="checkbox"/>	WEST ENTRANCE BANNER (QUANTITY 4+4) each	€ 8,000.00

VAT must be added to these figures, if due

NOTA BENE: these advertising solutions are just a part of a wider offer available.

Enada team is available for further customized solutions. Contact us.

Date _____

Stamp and signature of legal representative



ITALIAN EXHIBITION GROUP SpA
Via Emilia, 155 – 47921 Rimini, Italy
Ph. +39 0541 744111 Fax. +39 0541 744200
enada@iegexpo.it iegexpo@pec.it

C.F. PIVA 00139440408 Cap. Soc. 52.214.897 i.v.
Reg. Imp. di Rimini 00139440408 – R.E.A n. 224453



Ass. Naz. Servizi Apparecchi
per Pubbliche Attrazioni Ricreative
Italian Trade Association
of coin-op operators

ORGANIZED BY

**ITALIAN
EXHIBITION
GROUP**
Providing the future

IMPORTANT DEADLINES

AREA BOOKING AND TECHNICAL DEADLINES	REGISTRATION PROCEDURE:	A) The application form must be filled in and sent by post. IMPORTANT: forward the application form via email expo@iegexpo.it (For further details see General Rules and Regulations Chap. I Art. 2) Enada Team will contact you with a customized proposal.
	AREA ALLOCATION	NOVEMBER 2019 Exhibitors together with the Participation Proposal must send proof of the down payment as indicated in the document Participation Proposal.
	18 JANUARY	Deadline of the clause regarding reimbursement of the down payments ENADA PRIMAVERA 2019 (Chap I Art. 5 in Gen. Rules & Regulations).
	BALANCE DEADLINE	2 FEBRUARY deadline for forwarding Italian Exhibition Group the total balance payment for the exhibiting area allocated (Chap II Art. 3 of General Rules & Regulations).
	STAND PLANNING	15 FEBRUARY Deadline for the presentation of stand fitting & layout design to be loaded in the Reserved Area Section STAND PROJECTS
	SERVICES BOOKING	1 FEBRUARY Cut-off date for the presentation of the forms for ordering services (Available in the Reserved area of the exhibition)

WITHDRAWAL RULES	BY JANUARY 18 2019	If the written cancellation reaches the Organizer no later than 18 JANUARY 2019 , the penalty will be equal to an amount corresponding to the registration fee
	From 19 JANUARY 2019	If the written cancellation reaches the Organizer from 19 JANUARY 2019 , the penalty will be equal to an amount corresponding to the deposit as determined in the signed exhibiting proposal
	from 1 FEBRUARY 2019	if the written cancellation reaches the Organizer from the date of 1 FEBRUARY 2019 , penalty will be equal to an amount corresponding to the entire balance due as determined in the signed exhibiting proposal

	SECTOR	TEAM	TELEPHONE +39	EMAIL
Brand Manager	BRAND MANAGER	Orietta Foschi	0541 744 258	orietta.foschi@iegexpo.it
Info for exhibitors, exhibiting space sale , general information about the exhibition	SALES ACCOUNT	Eleonora Giovannini Amanda Reggiani	0541 744 477 0541 744 321	eleonora.giovannini@iegexpo.it amanda.reggiani@iegexpo.it
Technical assistance: online reserved area, services request (e-commerce)	TECHNICAL SERVICES Office	Debora Galletti Loredana Terranera Sabrina Bellini	0541 744 214 0541 744 915 0541 744 640	debora.galletti@iegexpo.it loredana.terranera@iegexpo.it sabrina.bellini@iegexpo.it
Technical assistance: logistics and planning fitting days, dismantling days, access procedure	GALS Office (logistic, fitting and security)	Andrea Silvagni Roberta Sarti	0541 744 887 0541 744 241	andrea.silvagni@iegexpo.it roberta.sarti@iegexpo.it
Accounting services: deposit payment, balance, invoices, request of invoices	ACCOUNTING DEPARTMENT	Evis Boshku Marilena Ventura	0541 744 219 0541 744 611	evis.boshku@iegexpo.it marilena.ventura@iegexpo.it
Assistance with filling in application forms, company details amendments and assistance with catalogue details	SALES BACK OFFICE	Gemma Chiarabini Simona Di Bartolo Margherita Morigi Isabella Fabbri	0541 744 259 0541 744 208 0541 744 292 0541 744 624	gemma.chiarabini@iegexpo.it simona.dibartolo@iegexpo.it margherita.morigi@iegexpo.it isabella.fabbri@iegexpo.it

WARNING! IMPORTANT INFORMATION FOR EXHIBITORS INTERNATIONAL FAIRS DIRECTORY

We hereby inform you that a company registered under the name , **International Fairs Directory** and with branches in other countries, has been sending forms to exhibitor firms asking for any modifications to their company data for publication of advertisements in an online magazine.

On completing and signing the forms, containing the names of Italian exhibition grounds and event trademarks, the firm is then obliged to pay a sum per year. **The above-mentioned company has NOT and has NEVER BEEN AUTHORISED to use neither our company name nor our event trademarks**

Should you receive forms or proposals from **International Fairs Directory**, we strongly recommend you to **READ THE TERMS VERY CAREFULLY** before signing anything.



ITALIAN EXHIBITION GROUP SpA
Via Emilia, 155 – 47921 Rimini, Italy
Ph. +39 0541 744111 Fax. +39 0541 744200
enada@iegexpo.it iegexpo@pec.it

C.F. PIVA 00139440408 Cap. Soc. 52.214.897 i.v.
Reg. Imp. di Rimini 00139440408 – R.E.A n. 224453



Ass. Naz. Servizi Apparecchi
per Pubbliche Attrazioni Ricreative
Italian Trade Association
of coin-op operators

ORGANIZED BY

**ITALIAN
EXHIBITION
GROUP**
Providing the future

PREALLESTITO MODELLO A4 - DIMENSIONI: 4X4

Allestimento

Pareti tamburato finitura laccata h 290 cm
Moquette rossa teatro 251
1 ripostiglio 100x100 cm
1 tavolo rettangolare 160x80xh 72 cm
3 sedie
1 sgabello
1 reception desk 100x40xh 100cm
1 cestino
1 appendiabiti

Impianto elettrico

1 quadro elettrico
1 multipresa 220 v
3 faretto 300w

Grafica standard

Prespaziata nera
(misure nette supporto 180xh 40 cm)

Il costo include inoltre: Tassa di iscrizione, assicurazione, pulizie, biglietti ridotti, 4 pass espositori, 1 parcheggio, wi-fi allo stand, l'area espositiva, 1 kw.

1 FRONTE ESPOSITIVO € 4.110,00 + IVA
SOCIO SAPAR € 3.890,00 + IVA



2 FRONTI ESPOSITIVI € 4.270,00 + IVA
SOCIO SAPAR € 4.050,00 + IVA



TURNKEY STAND A4 - SIZE: 4X4

Set up

Varnished wood walls h 290 cm
Red carpet
1 storage room 100x100 cm
1 rectangular table 160x80xh 72 cm
3 chairs
1 stool
1 reception desk 100x40xh 100 cm
1 waste bin
1 coat hanger

Electrical system

1 electrical board
1 socket 220 v
3 lamps 300w

Standard graphic

Black adhesive
(support's net size 180xh 40 cm)

Price also includes: Registration fee, insurance, cleaning, reduced tickets, 4 exhibitors badges, 1 parking pass, wi-fi, exhibit area, 1 kw .

1 OPEN FRONT € 4,110.00

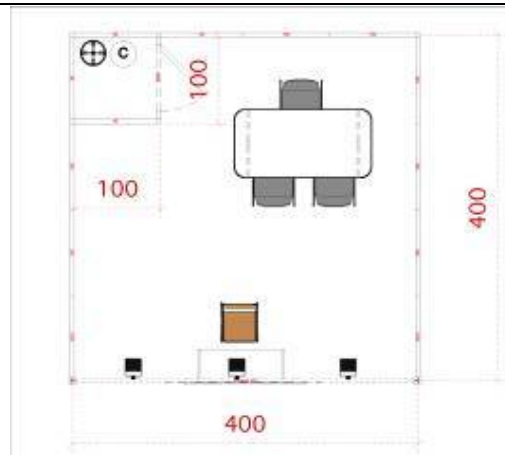

2 OPEN FRONTS € 4,270.00 + VAT

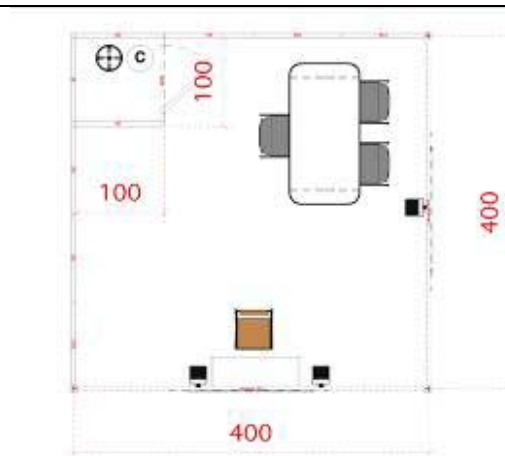

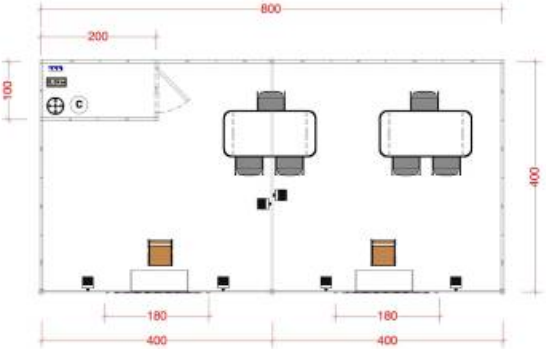
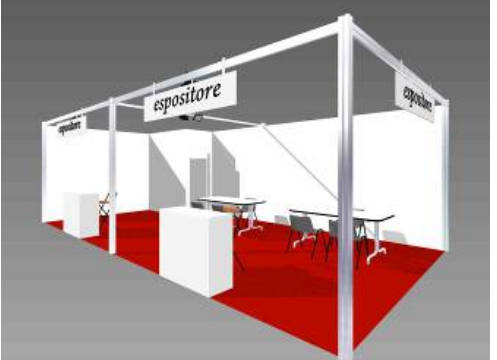
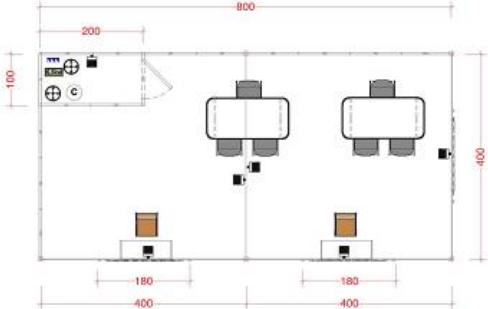
PREALLESITITO MODELLO A4 - DIMENSIONI: 8X4	TURNKEY STAND A4 - SIZE: 8X4
<p>Allestimento Pareti tamburato finitura laccata h 290 cm Moquette rossa teatro 251 1 ripostiglio 200x100 cm 2 tavoli rettangolari 160x80xh 72 cm 6 sedie 2 sgabello 2 reception desk 100x40xh 100cm 2 cestino 2 appendiabiti Impianto elettrico 1 quadro elettrico 2 multipresa 220 v 6 faretti 300w Grafica standard Prespaziata nera (misure nette supporto 180xh 40 cm)</p> <p>Il costo include inoltre: tassa di iscrizione, assicurazione, Pulizie, biglietti ridotti ,6 pass espositori, 1 Parcheggio, wi-fi allo stand, l'area espositiva, 2 kw.</p>	<p>Set up Varnished wood walls h 290 cm Red carpet 1 lumber room 200x100 cm 2 rectangular tables 160x80xh 72 cm 6 chairs 2 stool 2 reception desk 100x40xh 100 cm 2 waste bin 2 coat hanger Electrical system 1 electrical board 2 socket 220 v 6 lamps 300w Standard graphic Black adhesive (support's net size 180xh 40 cm)</p> <p>Price also includes: registration fee, insurance, cleaning, reduced tickets, 6 exhibitors badges, 1 parking pass, Wi-fi, exhibit area, 2 kw.</p>
<p>1 FRONTE ESPOSITIVO € 7.470,00 + IVA SOCIO SAPAR € 7.250,00 + IVA</p>	<p>1 OPEN FRONT € 7,470.00</p>
	
<p>2 FRONTI ESPOSITIVI € 7.790,00 +IVA SOCIO SAPAR € 7.570,00 +IVA</p>	<p>2 OPEN FRONTS € 7,790.00</p>
	

CONDIZIONI GENERALI DI FORNITURA

L'Espositore, dalla presa in consegna del materiale, è responsabile del corretto utilizzo dello stesso, intendendo con questo termine il normale stato d'uso, fino al momento della riconsegna, con l'impegno a coprire ogni ed eventuale onere derivante e/o conseguente all'uso improprio e/o non corretto dei materiali noleggiati fino al completo reintegro degli stessi nel caso non vengano restituiti.

SUPPLY GENERAL CONDITIONS

The exhibitor is accountable for the hired materials until the time of giving them back; he engages himself in covering every eventual burden deriving from the improper use of such material.